

S E R I E S

**D50**

R O L L E R



**PATENTED ROLLER  
DESIGN**

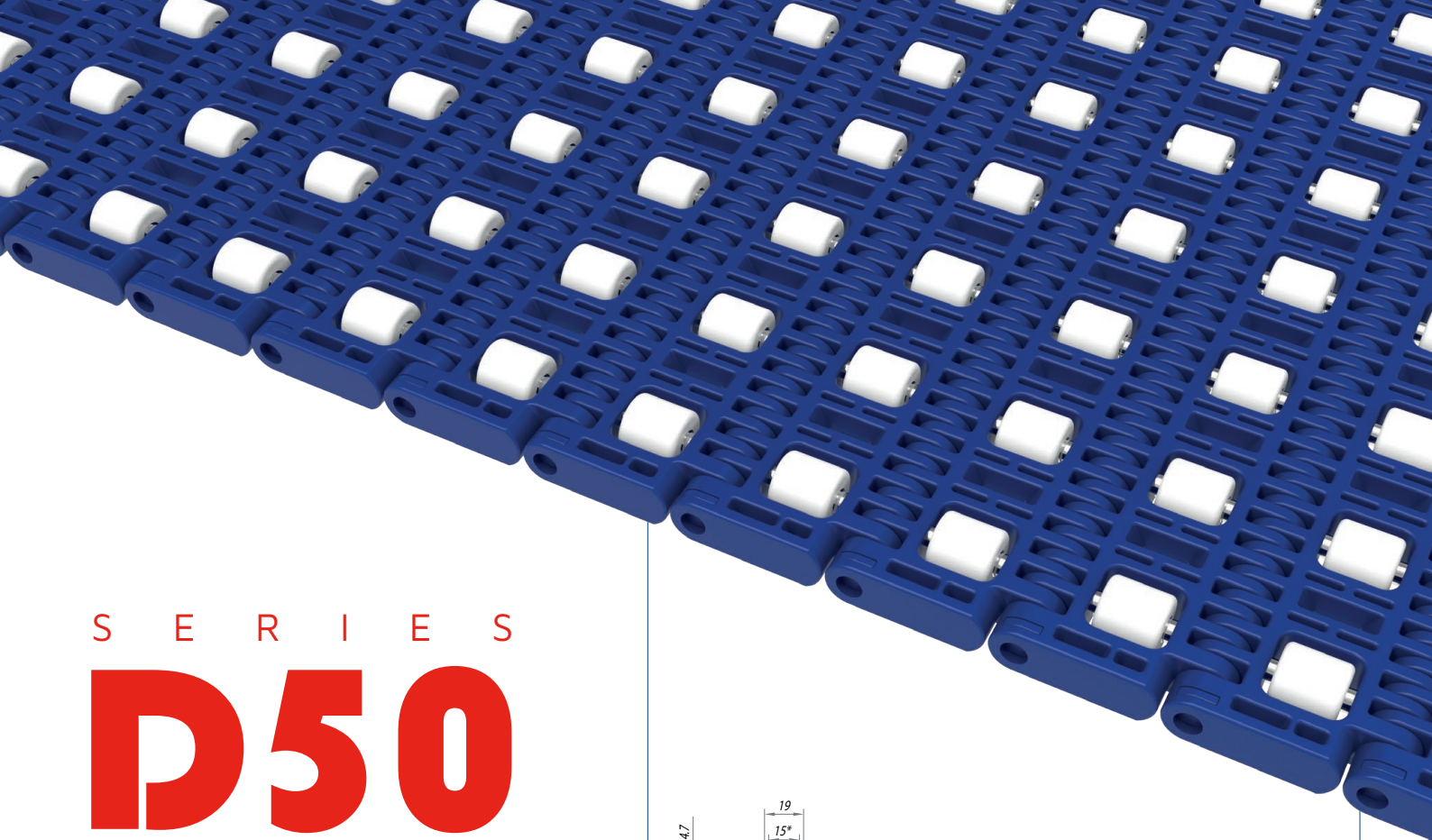

# S E R I E S

# D50

## R O L L E R 90°

### New EUROBELT D50 90 degree roller positioning

Our **innovative belt** makes the difference through patented design and process that maximises strength and durability. Specially designed to facilitate 90 degree transfers.

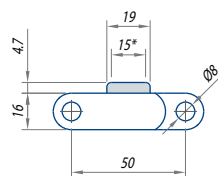

\*length of roller contact with product.

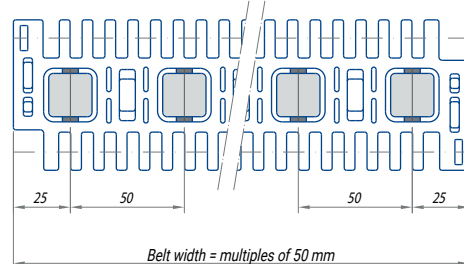

**Belt pitch**  
50 mm



**Belt width**  
Multiples of 50 mm



**Drive system**  
Central



**Ø min direct  
rotation roller**  
75 mm



**Ø min reverse  
rotation roller**  
150 mm

Belt surface	Belt material	Rod material (Ø 8 mm)	Belt resistance (kg/m)	Temperature limit (°C)	Standard colours	Belt weight (kg/m²)	Belt thickness	Open area
Roller 90°	PP-Polypropylene	Nylon	3650	+9 to +104	Blue	13,78	16 mm	17%



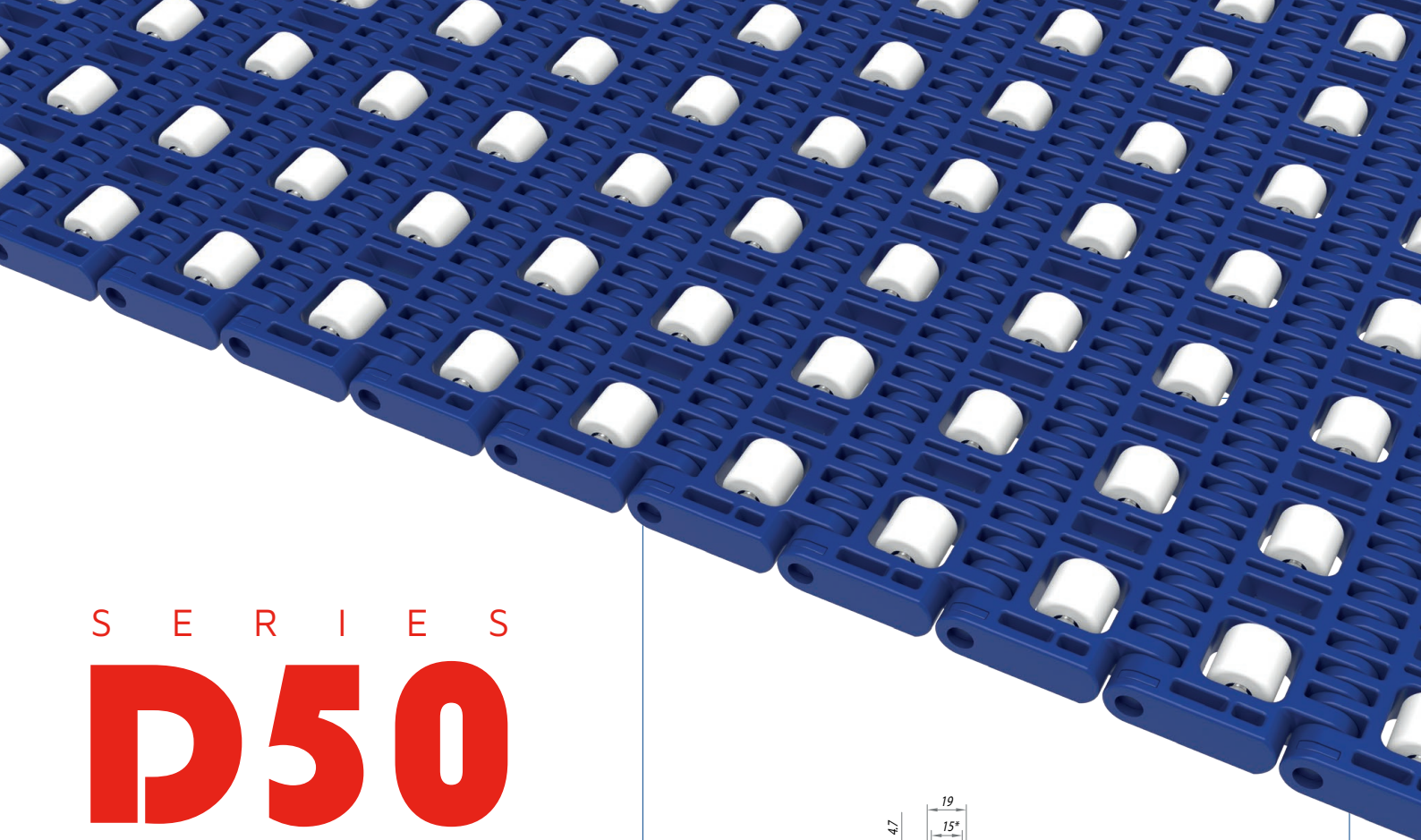

# S E R I E S

# D50

## R O L L E R 0°

### New EUROBELT D50

### 0 degree roller positioning

Our **innovative belt** makes the difference through patented design and process that maximises strength and durability. Designed for efficient accumulation, reducing friction and avoiding production jams.

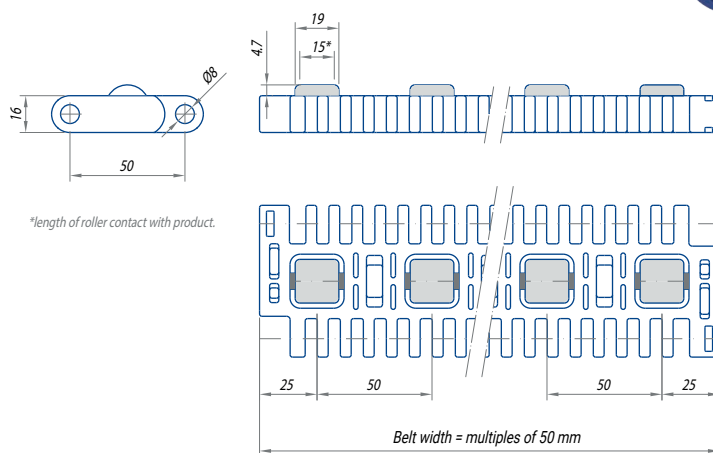

**Belt pitch**  
50 mm



**Belt width**  
Multiples of 50 mm



**Drive system**  
Central



**Ø min direct  
rotation roller**  
75 mm



**Ø min reverse  
rotation roller**  
150 mm

Belt surface	Belt material	Rod material (Ø 8 mm)	Belt resistance (kg/m)	Temperature limit (°C)	Standard colours	Belt weight (kg/m²)	Belt thickness	Open area
Roller 0°	PP-Polypropylene	Nylon	3600	+9 to +104	Blue	13,78	16 mm	17%

## Why choose Eurobelt D50?

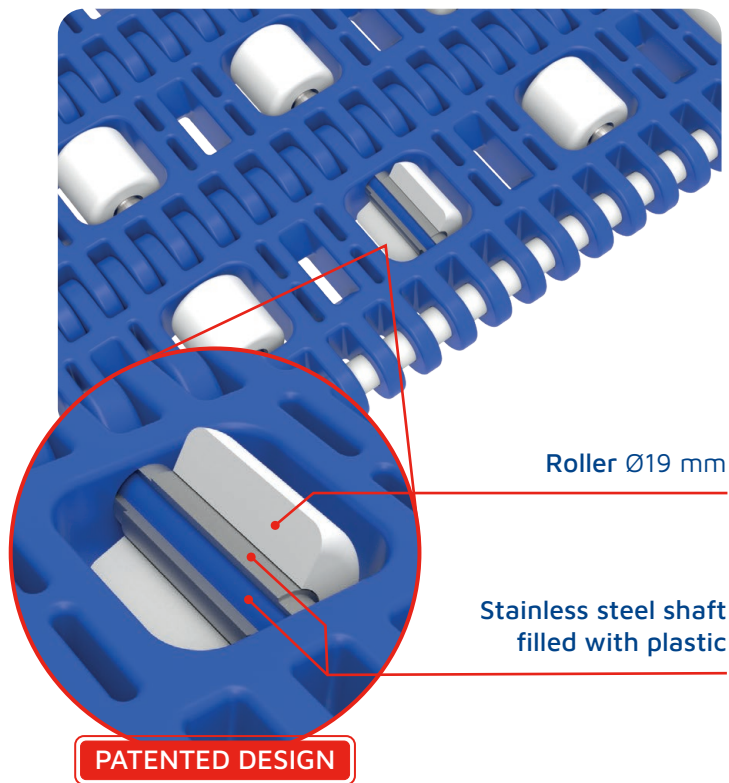

### Exclusive and patented roller design

By our our patented process, the roller rotates on a stainless steel shaft which is filled with plastic during the injection moulding process. In this way, an additional internal reinforcement is generated in the plastic module.

This technology optimises the dimensional stability of the belt during continuous strain and increases the traction resistance significantly, offering the longest durability on the market.

### Guaranteed superior durability

Our belt is equipped with an 8 mm connecting rod between modules. This technical detail ensures that the belt will withstand the most demanding conditions, increasing its working life and reducing the need for replacements.

### Ideal for lateral transfers

The 90 degree roller position means that lateral transfers are completely gentle, maintaining the integrity of each piece and minimising wear and tear in intensive applications.

Choose a belt that offers:

- ✓ More stability
- ✓ More endurance
- ✓ More uninterrupted operational time

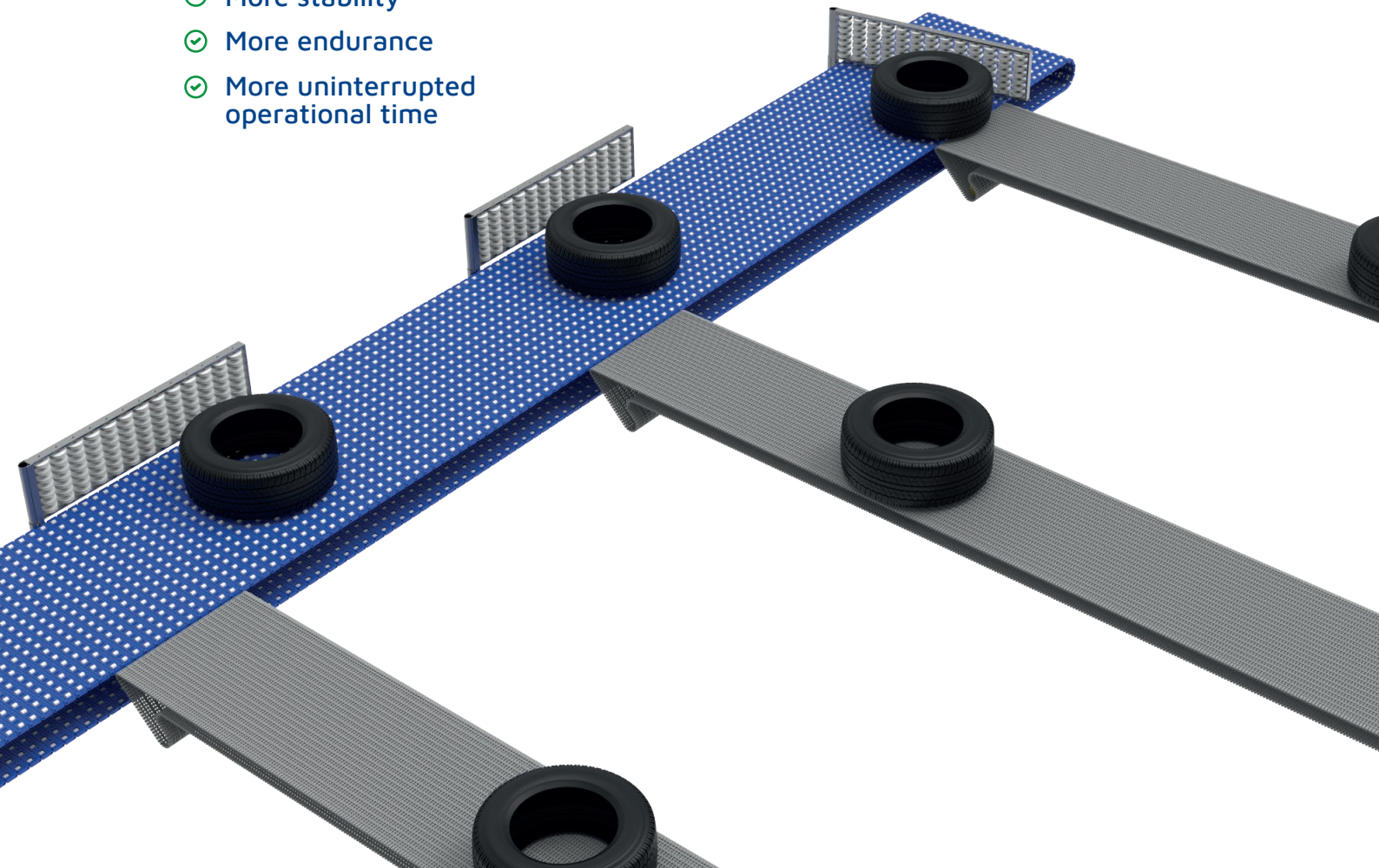



## SPROCKETS

Manufactured in acetal, nylon and stainless steel (check availability of other materials).

We also offer gears:

- For use with motor drum.
- Split sprockets, made to measure.

Consult available diameters and materials.

### MACHINED SPROCKETS



### SPLIT SPROCKETS

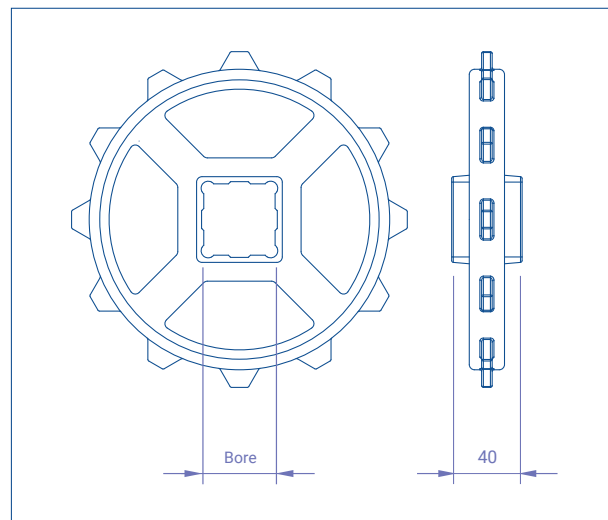

N° teeth Z	Ø Pitch	Bore for square shaft		Hub width
		mm	inch	
10	161,80	40 - 60	1,5 - 2,5	40
12	193,18	40 - 60	1,5 - 2,5	40
16	256,29	40 - 60	1,5 - 2,5	40

*Consult us for other diameters.*

## RETAINING RINGS

Eurobelt retaining rings are used to secure the central gear on the drive and driven shafts. They are placed on both sides of the central sprocket and are part of the self-guiding system of the modular belts, preventing the sprocket from sliding along the shaft and avoiding lateral displacements of the belt.

Additionally, the effects of temperature cause the belt to expand or contract.

The rest of the sprockets slide freely along the shaft, allowing them to adapt to the variations and lateral movements of the belt. This ensures that the correct tooth position is maintained at all times.

### CLE RETAINING RING

*\*See more in common accessories*



*AISI 316  
Stainless  
steel*

Bore for  
square shaft

Screws

20

M5x5

40

M6x6

60

M6x6

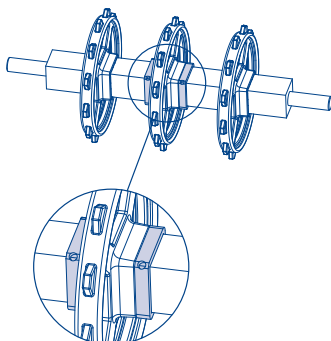

### CLU RETAINING RING

*\*See compatibility with diameters in common accessories*

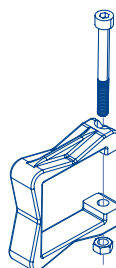

*Acetal  
High resistance*

Working temperature: +60°C / -40°C  
For bore square 40 mm or 1 1/2"

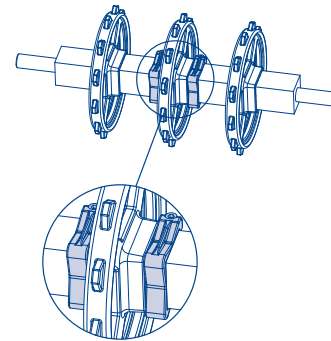

## SPROCKETS AND WEARSTRIPS

To calculate the necessary minimum quantity of sprockets for the drive shaft as well as for the idle one, the next formula has been used

$$\text{Minimum quantity} = \frac{\text{Belt width (mm)}}{150 \text{ mm}}$$

This amount must always be odd.

To calculate the quantity of supports, the weight of the product to be transported must be taken into account.

The distance between supports should not exceed 230 mm in the transport way or 300 mm in the return way.

Belt nominal width (mm)		Minimum quantity of sprockets per shaft	Minimum quantity of wearstrips	
			Transport way	Return way
150	150	1	2	2
200	250	2	2	2
300	450	3	2	2
500	750	5	3	3
800	1050	7	5	3
1100	1350	9	6	4
1400	1650	11	7	5
1700	1950	13	9	6
2000	2250	15	10	7
2300	2550	17	11	8
2600	2850	19	12	9
2900	3150	21	14	10
3200	3450	23	15	11
3500	3750	25	16	12
3800	4050	27	18	13

## HORIZONTAL CONVEYOR

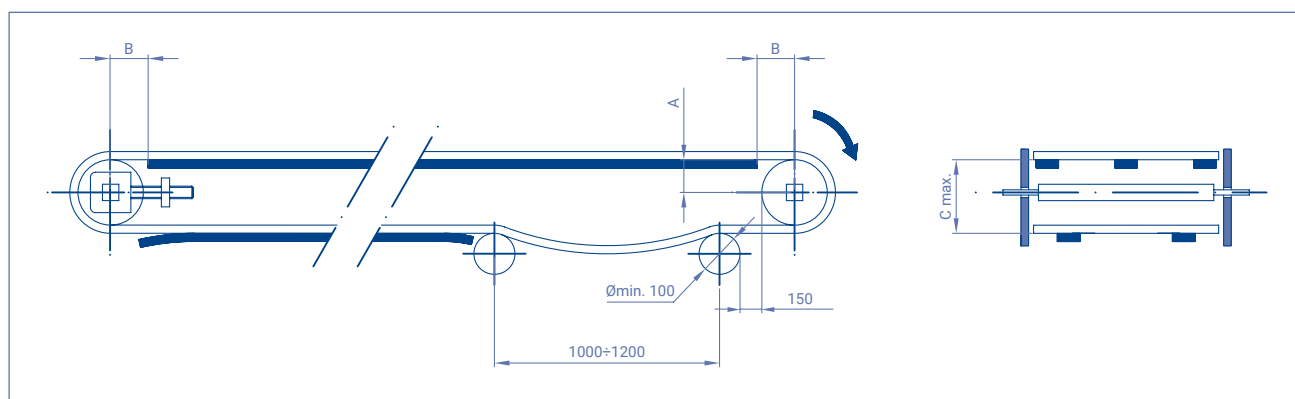

**[A]** Distance between the sliding surface of the belt and the centre of the shaft.

**[B]** Distance between the vertical of the shaft and the beginning of the sliding surface.

**[C]** Distance between the sliding surface of the belt and the support of the return way.

In the construction of conveyors, the distances appearing in the chart below must be respected according to the belt Series and the size of the sprockets.

N° teeth Z	Ø Pitch	A	B max.	C max.
10	161,80	72	76	165
12	193,10	89	78	200
16	256,29	120	80	260

## GUARANTEE AND LIMITATION OF LIABILITY

EUROBELT elements are guaranteed for a period of one year from the date of shipment with respect to the repair or substitution of any component whose materials or manufacture is defective, provided it is demonstrated that the work has been done under normal conditions of use.

No other expressed or implicit guarantee is given, unless it were set down in writing and approved by the manufacturer.

EUROBELT elements are manufactured with plastic materials. Consequently, their direct exposure to fire or to higher temperatures than those indicated can produce their deflagration together with the emission of toxic fumes.

Any use of the EUROBELT products has to observe the regulations and rules prevailing and the user is the only responsible to make observe these regulations when incorporating those products into any machine.

The data included here are of informative nature. Their applicability to the design of any installation is not guaranteed.

The manufacturer does not assume any responsibility for the repercussions derived from the use of his products, whether it is based or not on the information herein.

## CONTACT

Eurobelt offers its customers different communication channels, through which they can solve all their doubts related to our solutions in modular belts, as well as access to our recommendations when designing a complete internal transport system.

To the already traditional channels of communication, telephone, fax and email we have also incorporated the WhatsApp Channel and the Eurobelt AR Catalogue app, not forgetting our website, [www.eurobelt.com](http://www.eurobelt.com), in whose Client Area you can download numerous documentation, diagrams and technical data of all our products.

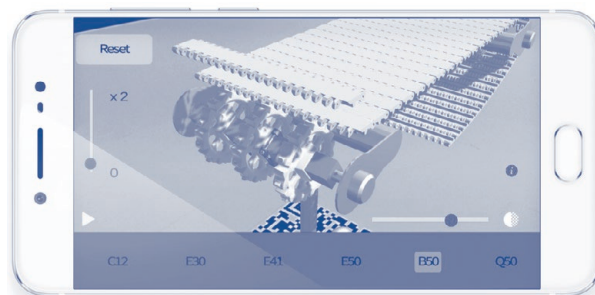



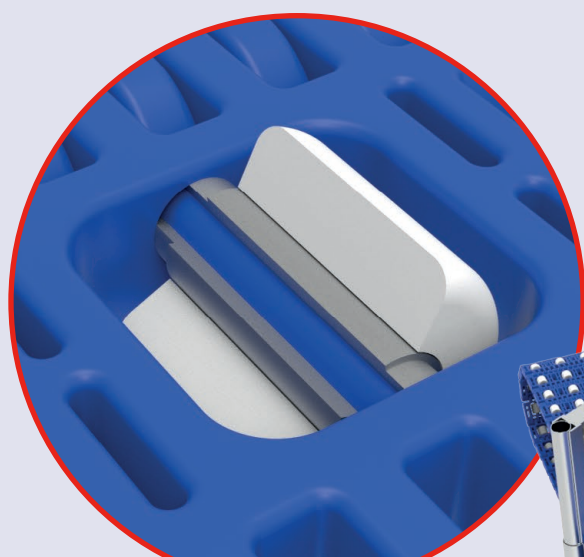
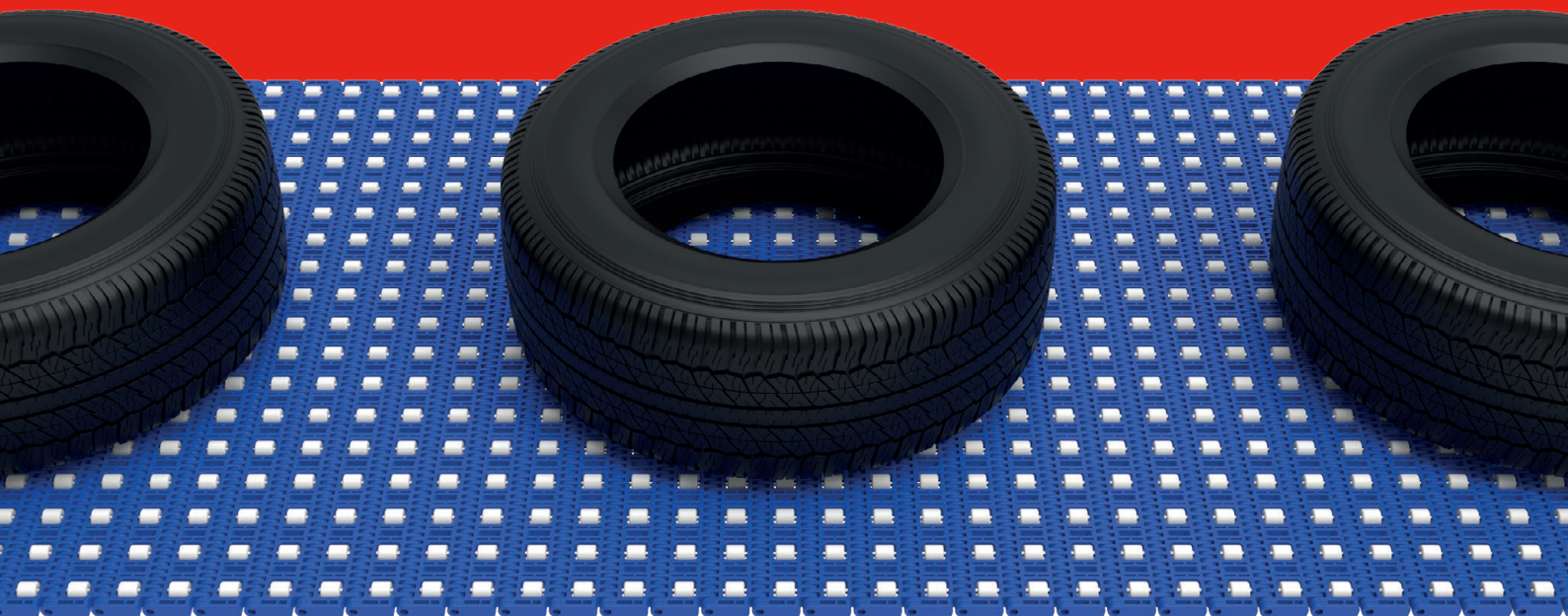

PATENTED DESIGN

S E R I E S

**D50**

R O L L E R

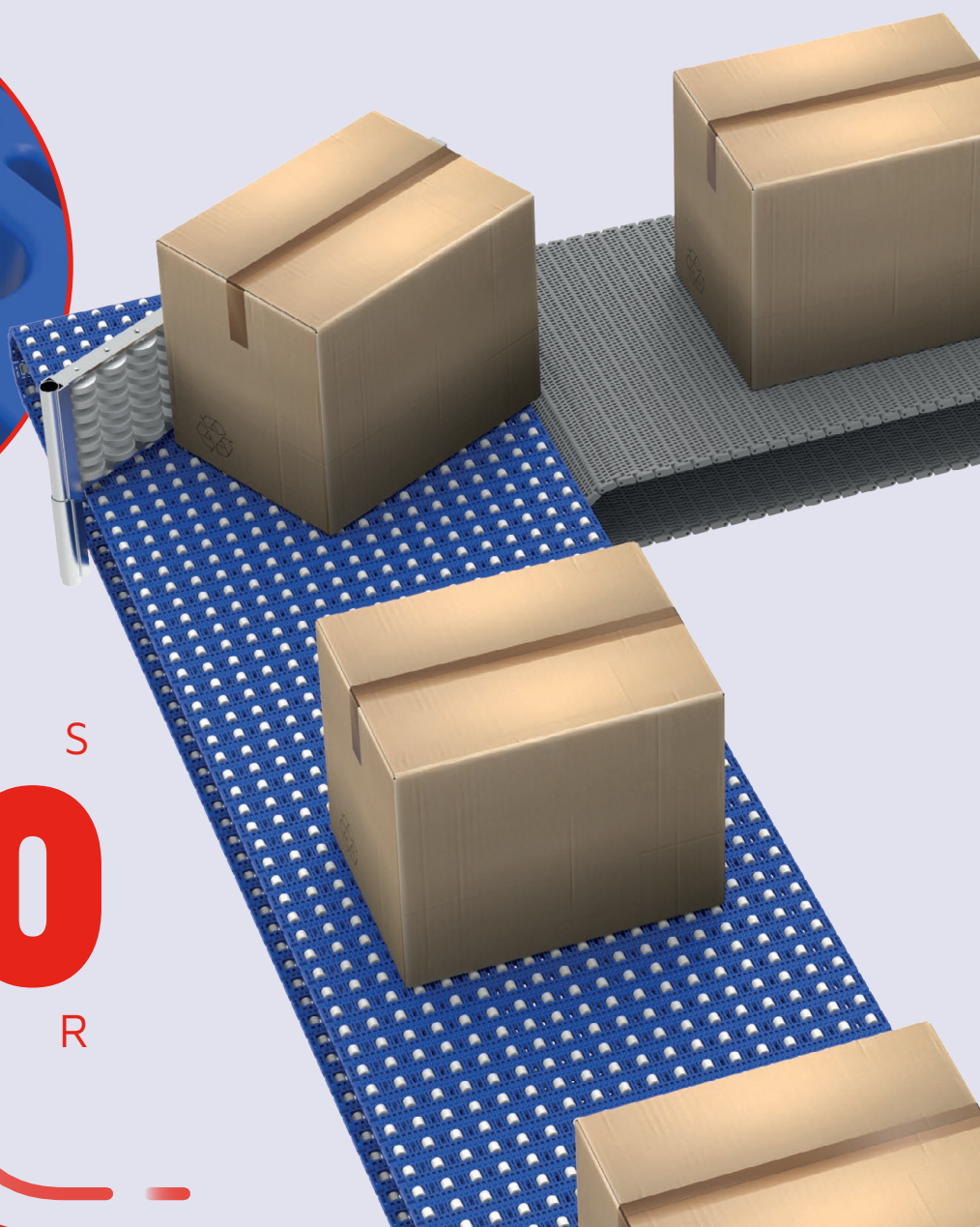

 **EUROBELT**

Topacio, 41 47012 - Valladolid (SPAIN)  
Telf.: +34 983 217 480  
e-mail: [after@eurobelt.com](mailto:after@eurobelt.com)

[www.eurobelt.com](http://www.eurobelt.com)