



# EUROBELT

MODULAR BELTS

*feel our motion experience*



S E R I E S

# C12

N U B T O P

The C12 NUBTOP Conveyor Belt is a **nonstick** modular belt with a FLUSH GRID open area which has been conceived for **very sticky products**. Their small reliefs, a sort of cylinder-shaped, prevent light wet products or coated products, which take the risk of getting lost during the process by falling to the ground or inside the machine, from adhering to the belt surface.

It is manufactured in **Polypropylene, Polyethylene** and **Acetal**, which observe the international regulations to be used in food processes.

Fish glazing  
Machines

Slicing  
Machines

Removal  
of Wastes

Eggs  
Transport

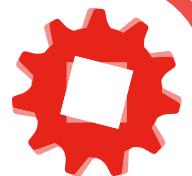



S E R I E S

# C12

N U B T O P

Food Nonstick Belt

### Detail of reliefs surface

Their **transversal disposition** avoids the retention of product wastes and helps the cleaning across the belt.

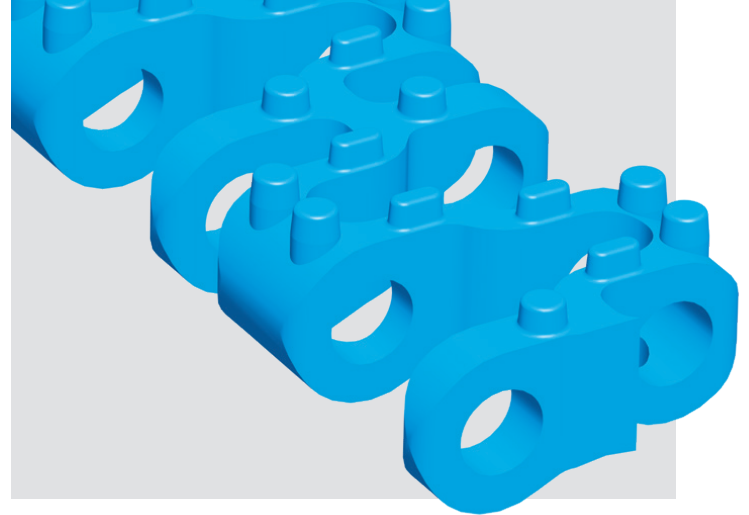

### Minimum Transfer dimensions

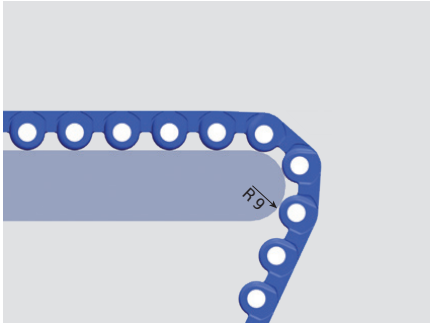

**Turning** in scarcely **18 mm**, the frozen products that stick to the belt will detach without the need to use scrapers.

### Double-Tooth sprocket

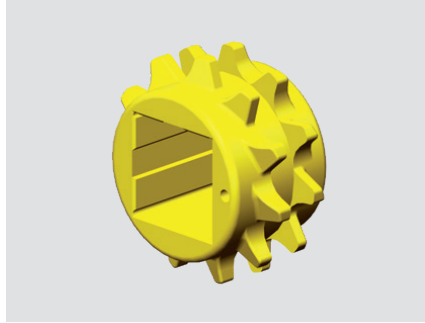

The small belt pitch, just 12 mm, is not a problem to assure an excellent drive by **double-tooth sprockets**. Sprockets with a diameter of just 42.59 mm are available for its traction.

### No-Cling flights

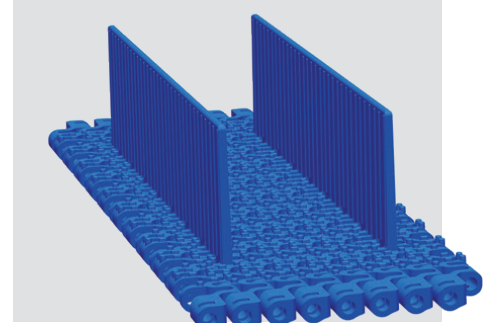

The equipment of this belt is completed by no-cling flights, so that this belt is the best option for **glazing fish** or processing of very light product sprayed by water.



Pitch  
**12 mm**



Thickness  
**9 mm**



Open Area  
**26 %**



Belt Width  
**x 25 mm**



Rod Diameter  
**4,6 mm**



Bidirectional



Nonstick Surface